

Road Map



Hybrid Map



Terrain Map



Floor Plan

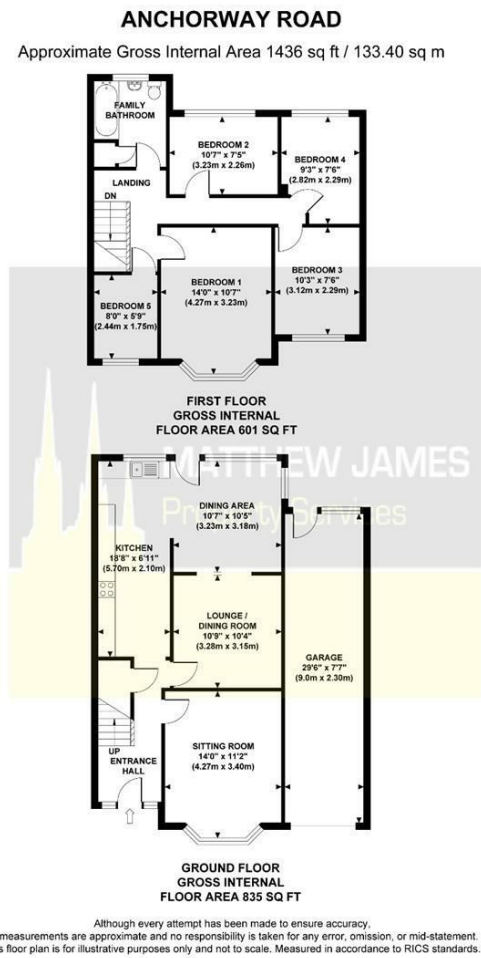

Viewing

Please contact us on 02477 170170 if you wish to arrange a viewing appointment for this property or require further information.

These particulars, whilst believed to be accurate are set out as a general outline only for guidance and do not constitute any part of an offer or contract. Intending purchasers should not rely on them as statements of representation of fact, but must satisfy themselves by inspection or otherwise as to their accuracy. No person in this firms employment has the authority to make or give any representation or warranty in respect of the property.

CONTACT INFORMATION

24a Warwick Row, Coventry CV1 1EY

02477 170170

info@matthewjames.uk.com

www.matthewjames.uk.com

Facebook

Twitter

**MATTHEW JAMES**  
Property Services



**165 Anchorway Road**  
Finham, Coventry CV3 6JH

**£390,000**

5 1 2 C





# 165 Anchorway Road

Finham, Coventry CV3 6JH

£390,000



## Approach

## Entrance Hall

## Lounge

10'9 x 10'4

## Kitchen

18'8 x 6'11

## Dining Area

10'7 x 10'5

## Sitting Room

14'0 x 11'2

## Upstairs Landing

## Bedroom One

14,0 x 10'7

## Bedroom Two

10'7 x 7'5

## Bedroom Three

10'3 x 7'6

## Bedroom Four

9'3 x 7'6

## Bedroom Five

8'0 x 5'9

## Family Bathroom

## Garage

27'11 x 7'6

## Rear Garden

